

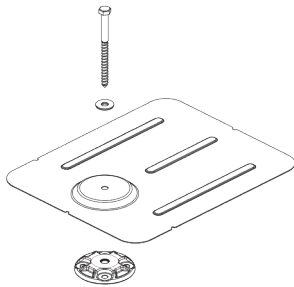

# Multi-Mount Roof Attachment

## Versatile Attachment Solution for Rooftop Solar Installations Single Puck Design - Three Versions

### Rafter Mount with Flashing 90231 - pack of 8



Kit includes flashing, puck, 5/16 x 4-inch lag bolt and sealing washer.

- Use to attach an L-foot to a rafter on a composition shingle roof.

\*L-foot is not included.

### Deck Mount with Flashing 90255 - pack of 8

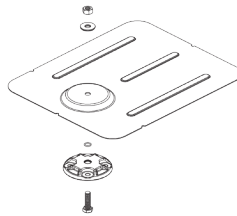

Kit includes flashing, puck, 5/16-inch bolt and nut, o-ring and sealing washer.

- Use to attach an L-foot or Standoff with flashing to a roof deck with four 1/4-inch screws.
- Use to attach an L-foot or a Standoff to a truss with two 1/4-inch or GRK type fasteners.
- Use to attach a Standoff to a rafter with two 1/4-inch fasteners.

\*Attachment screws not included.

### Base Kit without Flashing 90279 - pack of 8

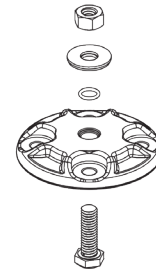

Kit includes puck, 5/16-inch bolt and nut, o-ring and sealing washer.

- Use to attach a standoff or an L-foot to deck with two 1/4-inch screws.
- Use without flashing.
- Can be attached to metal, torch-down or other smooth surfaces with appropriate sealant.

### Aluminum Standoffs Sold in packs of 8

90217 - 12-inch Standoff  
90170 - 4.5-inch Standoff  
90194 - 3.0-inch Standoff

- Standoffs can be used with the Standoff Base Kit and with the Deck Mount.
- Standoffs can be threaded together to make other lengths.
- L-foot mounts to 5/16-inch stud on top of Standoff.

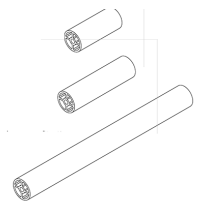

- Black painted aluminum flashing looks great on any roof
- 8-inch x 10-inch flashings will easily slide under shingles
- Raised section diverts water around puck
- Stainless-steel and rubber sealing washers to fit 5/16-inch bolts are included
- Meets or exceeds roofing industry best practice
- QR Code below links to installation video

